



台灣力得衛宇龍科技(股)公司

LEADERWAY CNC TECHNOLOGIES, CO., LTD..

EBM2150-5XC



5 AXES MACHINING CENTER

EBM-2150

- **TABLE DIMENSION : 2200MM × 1220MM**
- **X AXIS TRAVEL : 2150MM**
- **Y AXIS TRAVEL : 1400MM**
- **Z AXIS TRAVEL : 1100MM**
- **TABLE LOAD : 4000KG**

5 AUTOMATIC VERTICAL & HORIZONTAL BUILT-IN MOTOR SPINDLE HEAD

29.3Kw/14000rpm

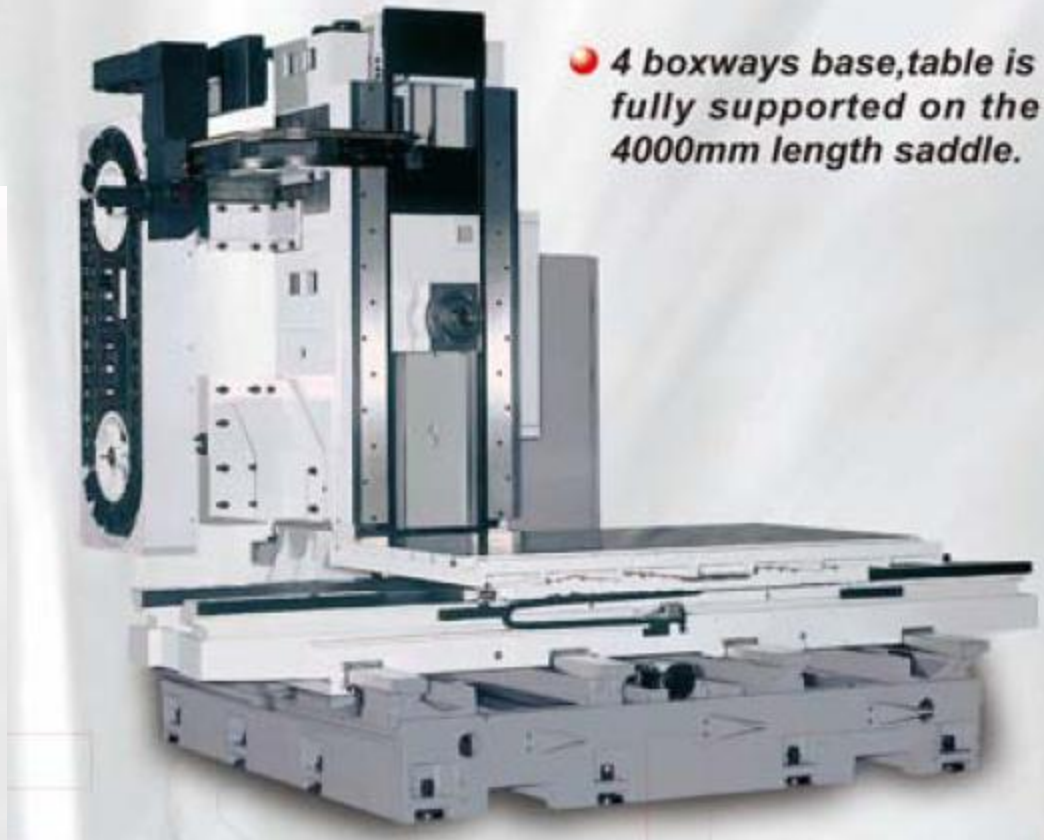

- **4 boxways base, table is fully supported on the 4000mm length saddle.**



EBM-2150 HORIZONTAL MACHINING CENTER WITH 32 TOOLS AUTOMATIC TOOL CHANGER (HORIZONTAL CHANGING) AND FOLLOWING OPTIONS :
—1200MM X 1200MM INDEXING TABLE.
—FULL GUARD WITH ROOF.

C AXIS DURABLE CNC ROTARY TABLE

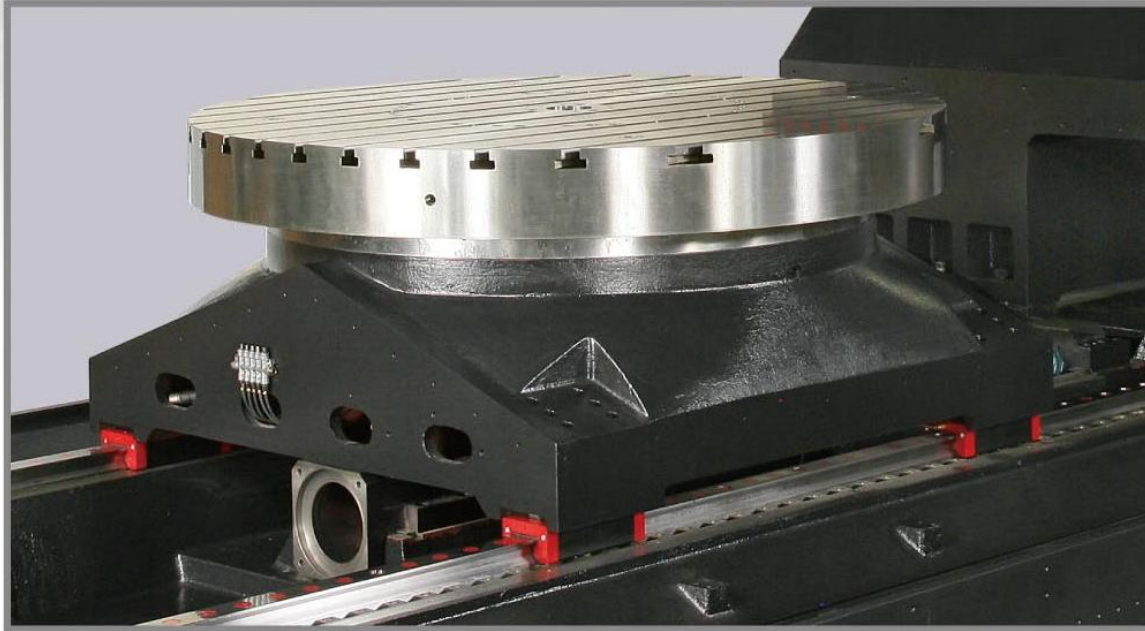

● STANDARD:

- ▶ $\phi 1300\text{mm}$ dimension with 4000kg load driven by AC servo motor, it can be indexing 0.001° by high precision worm gear, positioning by hydraulic cylinder; a high precision rotary encoder is included.

POWERFUL MOTOR SPINDLE



N14D Standard

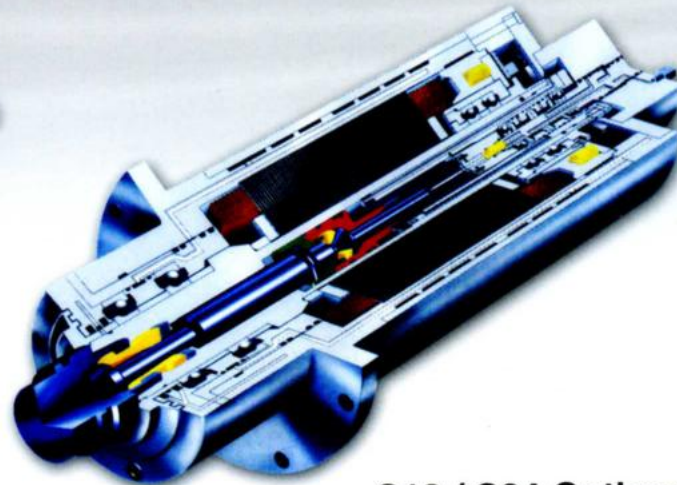

C18 / C24 Optional

Models	N14D	C18	C24
Max. speed - RPM	14000	18000	24000
Rated speed - RPM	4000	2000	4500
Spindle taper	BT#40	HSK-A63	HSK-A63
Housing diameter - MM	210	180	180
Power S1/S6 - KW	29.3 / 35	21 / 27	34 / 43
Torque S1/S6 - Nm	70 / 160	100/130	72 / 91
Bearings diameter - MM	70	70	65
Coolant thru spindle	OPT	OPT	OPT
Air thru spindle	N / A	OPT	OPT

STANDARD:

BT#40

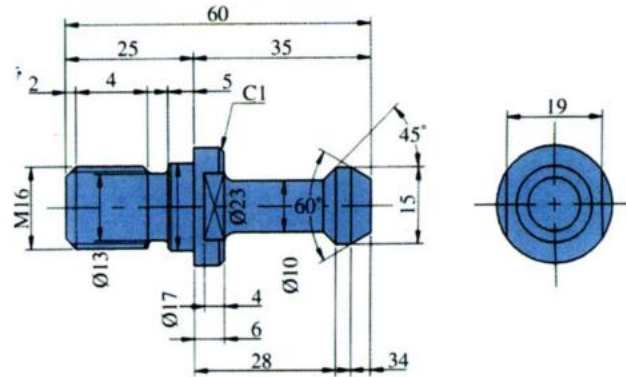
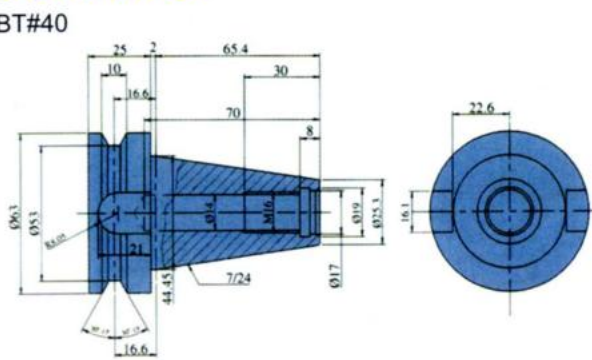

OPTIONAL:

HSK-A63

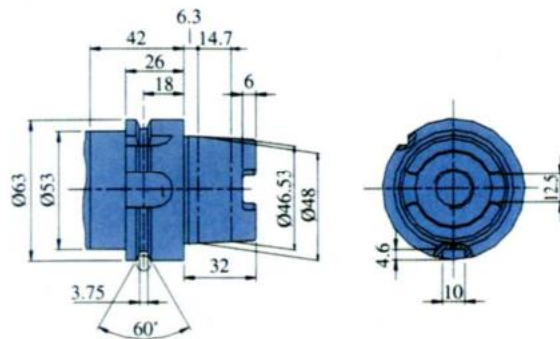

CAT-40 / DIN69871

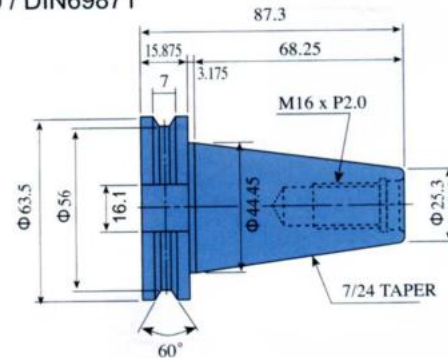

DIGITAL CNC CONTROL

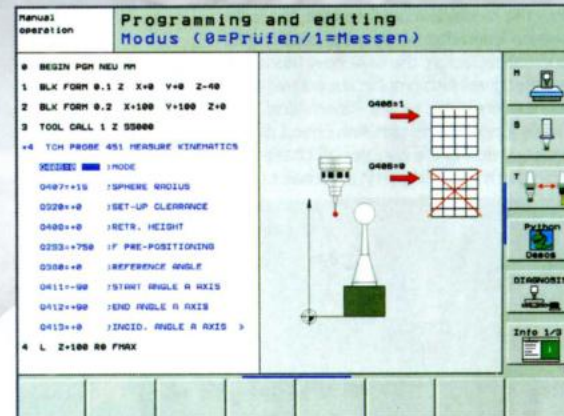

Inspecting and optimizing machine accuracy
by calibrating rotary axes with kinematics

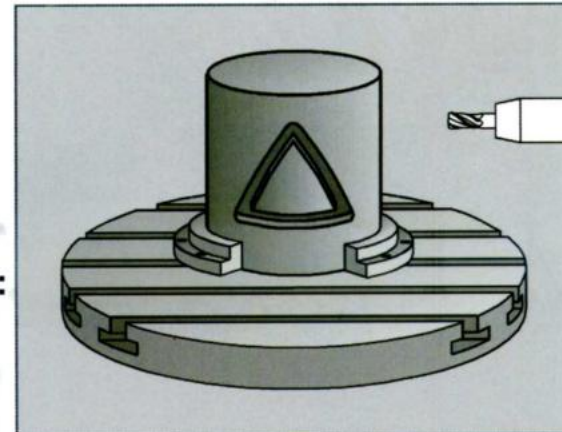

Cylindrical surface interpolation

Heidenhain iTNC-530 HSCI newest control :

1. MC 6222 1.8GHz more powerful CPU than before
2. 32G SSDR storage media resistance to vibration
3. New HEROS 5 operating interface with PDF viewer
4. TE 630 key board & MB 620 panel & 15" XGA screen



Large diameter ultra precision ballscrews directly coupled to the feed motor and are arranged in center of each guideways and close the cutting point.



Each ballscrew end support is with pre extended devices for absolute screw straightness and long life. (R.O.C.pantent no.72650)

OPTIONAL ACCESSORIES

1 AUTOMATIC TOOL CHANGER

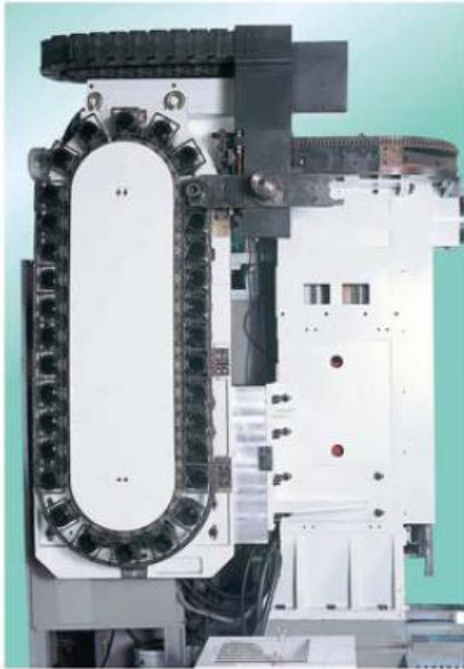

BT#50,40/60 tools swing arm automatic tool changer, exchange tools at horizontal spindle position, maximum tool's length: 400mm, weight: 15kg diameter: 125mm or 250mm with empty pockets.

2 DIRECT DRIVE SPINDLE: up to 15000 rpm (#40 Taper) or 10000 rpm (#50 Taper)



BT#40 16tools swing arm ATC.

MODEL	UNIT	EBM-1000	EBM-2150	EBM-2600	EBM-3200
TABLE:					
OVERALL SIZE	MM	1500×710	2200×1220	2650×1220	3250×1220
WORKING AREA	MM	1500×710	2200×1100	2650×1100	3250×1100
T SLOTS (SIZE NO PITCH)	MM	18×6×125	22×7×125	22×7×125	22×7×125
MAXIMUM LOADING	KG	1500	4000	4500	5000
TRAVEL:					
X / Y / Z AXIS	MM	1400/1200(1400)/1000	2150/1400/1100	2600/1400/1100	3250/1400/1100
DISTANCES:					
SPINDLE NOSE TO TABLE EDGE	MM	246.5-1246.5	-249-930	-249-930	-249-930
SPINDLE CENTER TO TABLE TOP	MM	250-1450(245-1645)	190-1590	190-1590	190-1590
SPINDLE NOSE TO COLUMN SURFACE	MM	250	249	249	249
FLOOR TO TABLE	MM	980	995	995	995
SPINDLE:					
TAPER	ISO	BT#50	BT#50	BT#50	BT#50
SPEED	RPM	4000(6000)	4000 (6000)	4000 (6000)	4000 (6000)
MOTOR	KW	15	15	15	15
AXIS MOTORS:					
X & Z AXIS	NM	22 / 22	27 / 27	27 / 50	70 / 70
Y AXIS	NM	22 WITH BRAKE	27 WITH BRAKE	27 WITH BRAKE	27 WITH BRAKE
CUTTING FEEDRATE	MM/MIN	1-5000	1-5000	1-5000	1-5000
RAPID FEEDRATE	M/MIN	10(15)	10(15)	10(15)	10(15)
MINIMUM SETTING	MM	0.001	0.001	0.001	0.001

AUTOMATIC TOOL CHANGER :					
TYPE OF ATC		SWING ARM	SWING ARM	SWING ARM	SWING ARM
NO.OF ATC	TOOLS	32 (40,60)	32 (40,60)	32 (40,60)	32 (40,60)
MAX.TOOL (DIA/LENGTH)	MM	250 / 300	250 / 300	250 / 300	250 / 300
MAX.TOOL WEIGHT	KG	15	15	15	15
TOOL TO TOOL	SEC.	3.5	3.5	3.5	3.5
BALLSCREWS ON X / Y / Z :					
DIAMETER	MM	50 / 50 / 50	63 / 50 / 63	63 / 50 / 63	63 / 50 / 63
PRECISION CLASS(C3)	MM/300MM	0.008	0.008	0.008	0.008
COOLANT & LUBRICATION :					
COOLANT MOTOR POWER	KW	0.86	0.86	0.86	0.86
COOLANT TANK VOLUMN	L	200	350	350	350
COOLANT MOTOR CAPACITY	L / MIN	20	20	20	20
LUBRICCATION MOTOR POWER	WATT	25	25	25	25
LUBRICATION TANK VOLUME	L	4	4	4	4
ACCURACY :					
POSITIONING	MM	JIS 6388 : $\pm 0.005\text{MM} / 300\text{MM}$ VDI3441 : P0.014MM			
REPEATABILITY	MM	JIS 6388 : $\pm 0.003\text{MM}$ VDI3441 : PS0.01MM			
ROUNDNESS	MM	JIS 6388 : $\pm 0.01\text{MM}/300\text{MM DIAMETER}$			
MISCELLANEOUS :					
MACHINE NET WEIGHT	KG	15000	21000	23000	25000
POWER REQUIRED	KVA	30	35	40	40
PNEUMATIC REQUIRED	KG / CM ²	7	7	7	7

() OPTIONS

STANDARD FEATURES & ACCESSORIES :

1. PROGRAMMABLE COOLANT SYSTEM
2. AUTOMATIC LUBRICATION SYSTEM
3. SPINDLE AIR BLAST SYSTEM
4. WORKING LAMP
5. ALARM LAMP FOR ABNORMAL SITUATION
6. INDICATION LAMP FOR DWELL & END OF JOB
7. LEVELLING BOLTS & PADS
8. BT#50 SPINDLE
9. PRE-EXTENSIONED BALLSCREWS
10. RS-232 TERMINAL INTERFACE PORT
11. MACHINE & CONTROL MANUALS
12. TOOLBOX WITH SPANNERS & WRENCHES

CNC CONTROLS AVAILABLE: FANUC, MITSUBISHI, HEIDENHAIN, SELCA, SIEMENS

OPTIONAL ACCESSORIES :



TOOL PROBE



TOOL LASER MEASUREMENT



WORK PLECE PROBE



**COOLANT THUR SPINDLE
DEVICE**

APPLICATIONS

► The milling center can be used not only the typical various turbo impeller industries but also servicing aerospace aviation, automotive and mould industries etc.

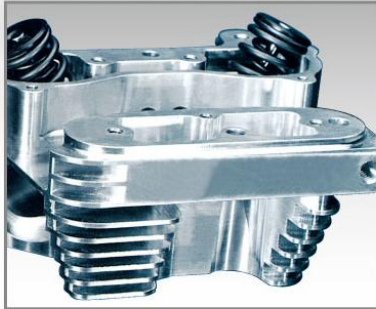

1. CYLINDER



2. SHAFT

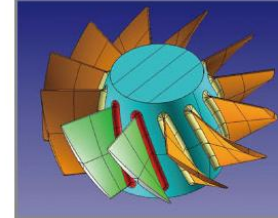
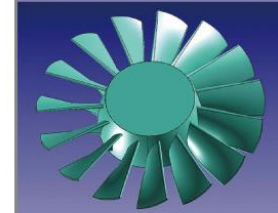

5. BLISK



3. MOULD



4. WHEEL



6. TURBO IMPELLERS



10-BLADES



16-BLADES



Thanks for your attentions.

